



MONDERA

Less Space, More Life





Who We Are?

We are a manufacturing brand based in Gaziantep, specialized in light-steel and modular construction with a strong focus on export. We combine years of production experience with a quality-driven, well-structured process approach.

What We Do?

- Tiny houses and modular living units
- Steel villas, modular houses, modular offices, and sales kiosks
- Project-specific light-steel frame manufacturing
- Modular solutions for public projects (site offices, health/education units, temporary accommodation)
- Modular units and blocks for mass housing (serial production, fast installation)



Why TSD?

Trust: Contract-based and transparent processes; an approach that inspires confidence at every stage.

Quality: Manufacturing to European standards, superior insulation performance, and structural assurance for maximum durability.

Aesthetics: Modern architectural lines, premium finishes, carefully considered details.

Experience: Know-how accumulated from dozens of projects; engineering assurance embedded in every detail.

Customer Satisfaction: Needs-oriented solutions, after-sales support, and long-term assurance.

Bespoke Production: We design your dream living space to your specifications and manufacture in full compliance with all relevant European technical standards.

Delivery: Fast and trouble-free delivery in 40–45 days for standard models.

Turnkey: Our models are delivered turnkey; they can be put into use immediately with only electricity and water connections—no construction process required.

Mondera Series

Mondera: 40 m² Premium 1+1 Tiny House (1 bedroom + 1 living area) Mondera is a 1+1 premium living unit developed by TSD specifically for the European market. It has been optimized for use cases such as a comfortable holiday home outside the city, an additional living space in the garden, a showroom, or short-term rental. Dimensions can be customized on request.

Highlights

Hybrid Structural System: Combination of heavy steel and light steel; maximum durability and structural reliability.

Smart Layout: Spacious living in a 1+1 floor plan.

Optimized for European Logistics: Transport dimensions and connection details are designed accordingly.

Elegant Facade: Modern lines and low-maintenance materials.



Turnkey Use: Our models are delivered turnkey; after connecting electricity and water they are immediately ready for use—no construction process required.

High Thermal and Acoustic Insulation: Superior insulation technology for comfortable living in all seasons.

Quality at European Standards: Full compliance with international quality norms in materials and manufacturing.

Energy Efficiency: Structures that minimize heat losses and provide low energy consumption.

Aesthetics Meets Function: Maximum usable area with modern design.

Long-Lasting Materials: Corrosion-resistant steel and premium cladding options.

Easy Transportability: Safe shipping and installation to different locations.

Versatile Use: Suitable as a holiday home, office, showroom, or for rental.

Customer-Centric Solutions: Interior layout and equipment can be customized to your needs.

Experience: Assurance backed by TSD's expertise in the steel-construction sector.



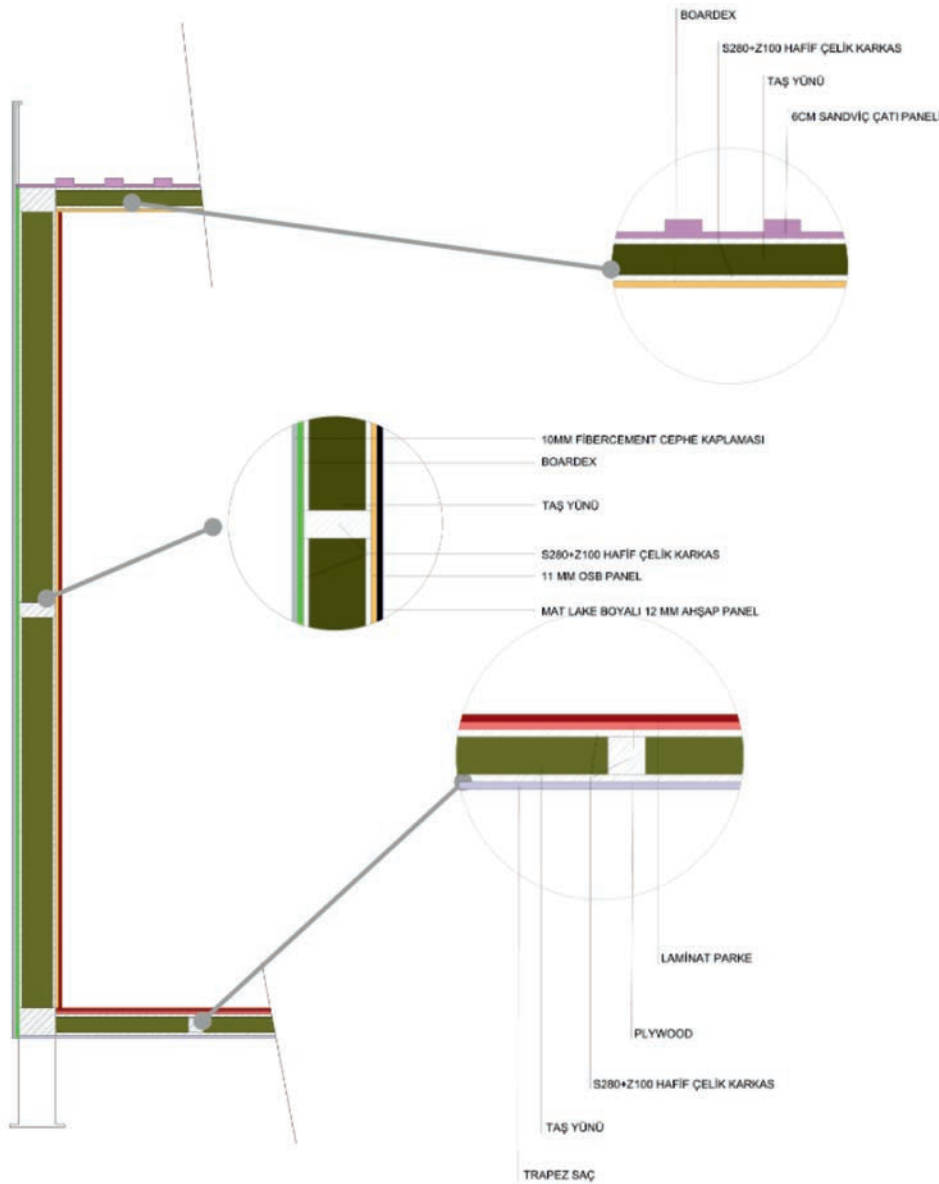

FLOOR

Trapezoidal steel deck
10 cm stone wool
Vapor barrier
18 mm plywood
Laminate flooring

INTERIOR WALL

10 cm stone wool
11 mm OSB board
12 mm matte-lacquered
wooden panel

EXTERIOR WALL

10 cm stone wool
Vapor barrier
12.5 mm Boardex panel
(exterior sheathing)
10 mm fiber-cement board

ROOF

10 cm stone wool
Vapor barrier
12.5 mm Boardex panel
6 cm sandwich panel

WINDOW

Thermally insulated aluminum
frames with tempered, reflective glazing

PLUMBING (MECHANICAL)

Composite PPRC potable-water line and PVC
wastewater installation

ELECTRICAL

Electrical installation with
flame-retardant cables

BEDROOM

(Details can be customized
based on project requirements)

KITCHEN

Kitchen to be built with
matte-lacquered finishes;
color to be selected by the customer



MONDERA PLAN

DIMENSIONS

Length – 12 m

Width – 3.30 m

Interior height – 2.70 m

Exterior height – 3.50 m



MONDERA SECTION

STRUCTURE

We adopt a hybrid load-bearing concept in our projects: heavy steel for the main load-bearing chassis and the columns-and-beams; and S280+Z100-grade light steel for the panels and secondary members. This combination brings together high load capacity, stiffness against vibrations, low weight, and superior corrosion resistance in a single structure. All elements are produced to millimeter precision using CNC cutting and roll-forming technology.



Mondera Series



Mondera Series





Mondera Series





Sanayi Mh. 60231, Cd.
No: 22, 27000
Şehitkamil/Gaziantep

+90 532 459 19 27

export@tsdcelikyapi.com

www.tsdcelikyapi.com

MONDERA